

TEXAS A&M HEALTH SCIENCE CENTER PARKING DETAIL

EMT CPR Trainings Park in "Lot 3" ONLY

Follow sidewalk to the back entrance of
Clinical Building 1 - Enter rear lobby and
take East elevator to 3rd floor,
room #: HSC3541

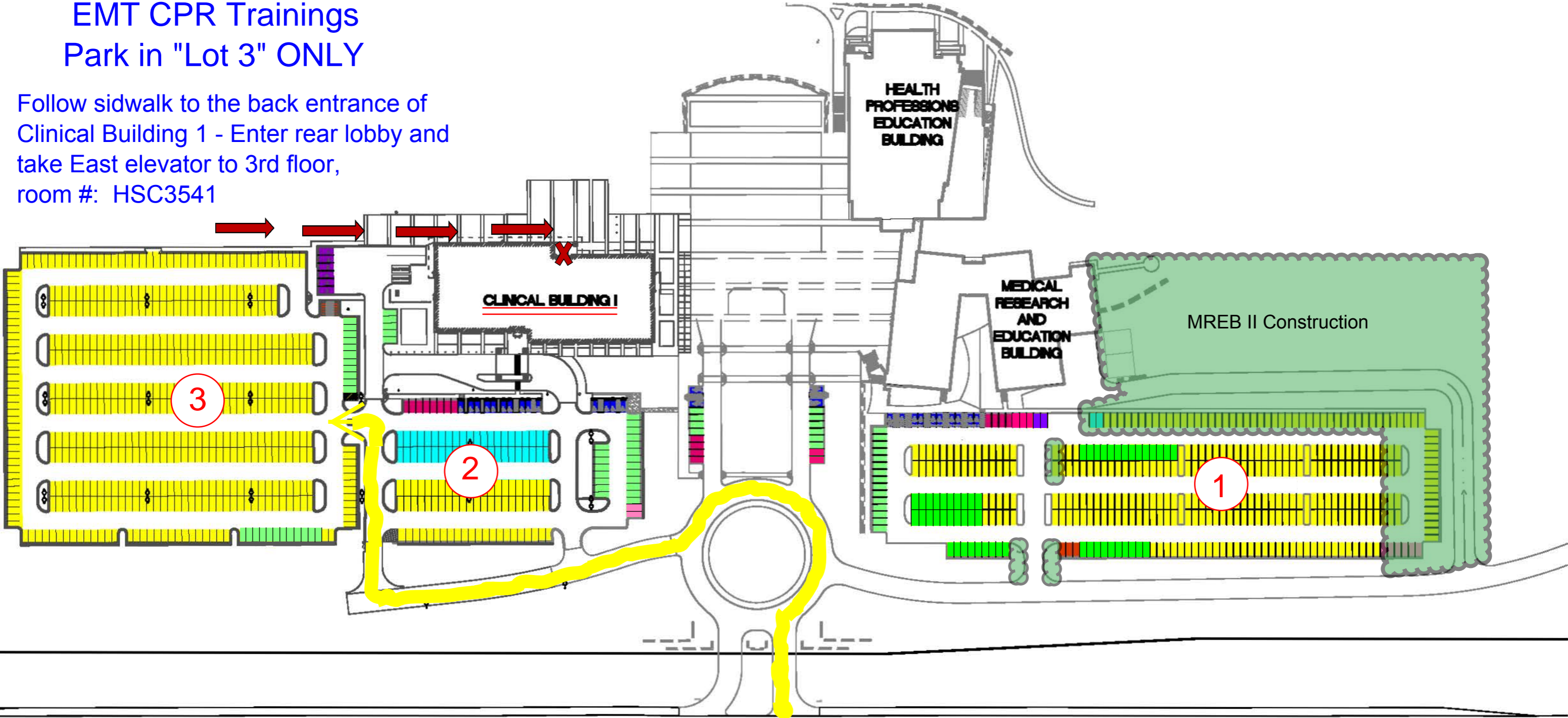

- | | |
|---|--|
| 24 HOUR RESERVED SPACES | SERVICE PARKING |
| PATIENT PARKING | GENERAL PARKING |
| VISITOR PARKING - 60 MINUTE | HANDICAP PARKING |
| HSC VEHICLES | MOTORCYCLE PARKING |